

## APPLICATIONS

The MQ booster pump is a self-priming compact unit designed for the distribution and boosting of clean domestic water. Its integral tank avoids the need for a cumbersome additional water tank and enables quick installation in confined spaces.

## FEATURES



- Quiet operation
- Protection against dry running
- Suction lift: up to 6.5 metres (see operating instructions for maximum suction pipe length)
- Built-in non-return valve
- Supplied with an electric cable (2m) and plug
- Motor with thermal protection
- Discharge outlet adjustable by +/-5° to facilitate hose attachment

## CONSTRUCTION

- Stainless steel pump housing
- Integrated 0.4 litres diaphragm tank
- IP54 motor
- Insulation Class B
- Voltage: 1 x 240 V - 50 Hz

## PERFORMANCE

Pumps	Discharge Pressure (kPa/psi)					
	150	200	250	300	350	400
	22	29	36	44	51	58
Output (l/min)						
MQ3-35	61	50	39	24	-	-
MQ3-45	66	58	49	39	27	13

As a guide 1 tap  = 10 litres per minute • 1 sprinkler  = 15 litres per minute

## TECHNICAL FEATURES

Pumps	P2 (W)	In (A)	Water temp	Connections		Weight (kg)
				inlet	outlet	
MQ3-35	550	4.0	0/35°C	1" M	1" M	13
MQ3-45	670	4.5	0/35°C	1" M	1" M	13

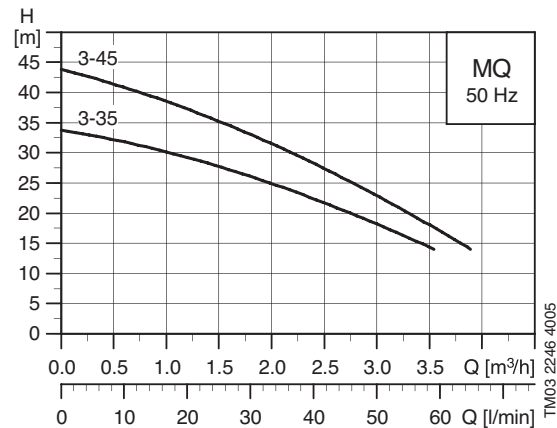

## DIMENSIONS / INSTALLATION

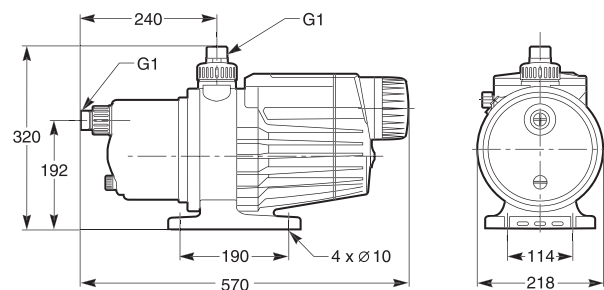

Dimensions in mm

The MQ booster pumps integrated control unit automatically protects against:

- dry running
- motor overheating
- motor overload

In the event of a fault, the MQ stops automatically, then tries to restart after half an hour.